

# SKETCH

FOR PROPERTY OF

## BRYDEN BROS LIMITED

SHOWING

### PID 01438118

569 WOODSTOCK ROAD  
CITY OF FREDERICTON  
COUNTY OF YORK  
PROVINCE OF NEW BRUNSWICK

#### NOTES

1. AZIMUTHS ROUNDED TO NEAREST 10 SECONDS.
2. BUILDING TIES SHOWN HEREON ARE TO THE EXTERIOR LIMITS OF THE FOUNDATION.
3. ALL DIMENSIONS ARE EXPRESSED IN METRES AND DECIMALS THEREOF AND MAY BE CONVERTED TO FEET BY DIVIDING BY 0.3048.
4. ALL DISTANCES AND DIRECTIONS ARE CALCULATED UNLESS NOTED OTHERWISE.
5. AZIMUTHS ARE N.B. GRID NORTH DERIVED FROM GLOBAL POSITIONING.
6. COMBINED SCALE FACTOR OF 1.000000 APPLIED.
7. BUILDING TIES SHOWN HEREON ARE PERPENDICULAR TO PROPERTY SIDELINES.
8. THE INFORMATION EXPRESSED ON THIS PLAN IS ISSUED TO and MAY BE RELIED UPON SOLELY BY THE PROPERTY OWNER FOR WHOM THIS PLAN WAS PREPARED. WE ASSUME NO RESPONSIBILITY OR LIABILITY BY THIRD PARTY RELIANCE ON AFORESAID INFORMATION.

#### LEGEND

- STANDARD SURVEY MARKER FOUND
  - STANDARD SURVEY MARKER PLACED
  - IRON PIPE FOUND
  - ROUND IRON BAR FOUND
  - SQUARE IRON BAR FOUND
  - WOODEN SURVEYOR'S POST
  - CALCULATED POINT
  - UTILITY POLE
  - SURVEY SYSTEM COORDINATE MONUMENT
  - TABULATED COORDINATE VALUE
  - BOUNDARIES DEALT WITH BY THIS PLAN
  - EASEMENT
  - NBLS SURVEYOR NUMBER
  - DEED TRACT LINE
  - PUBLIC UTILITY EASEMENT
  - LOCAL GOVERNMENT SERVICES EASEMENT
  - SQUARE METRES
  - HECTARE
  - SNB PARCEL IDENTIFIER
  - DOCUMENTS ARE FILED IN THE COUNTY REGISTRY OF PROPERTY LOCATION
- #356
- P.U.E.  
L.G.S.E.  
sq. m.  
Ha.  
PID 12345678



SCALE 1:250



CONSULTING ENGINEERS & SURVEYORS

# SURTEK GROUP LTD.

101-411 St. Mary's Street  
Fredericton, NB E3A 8H4

Phone: 454-7044

Fax: 454-1147

Email: Office@SurTek.ca

DRAWING : 25375-PARKING

FILE No : 25375

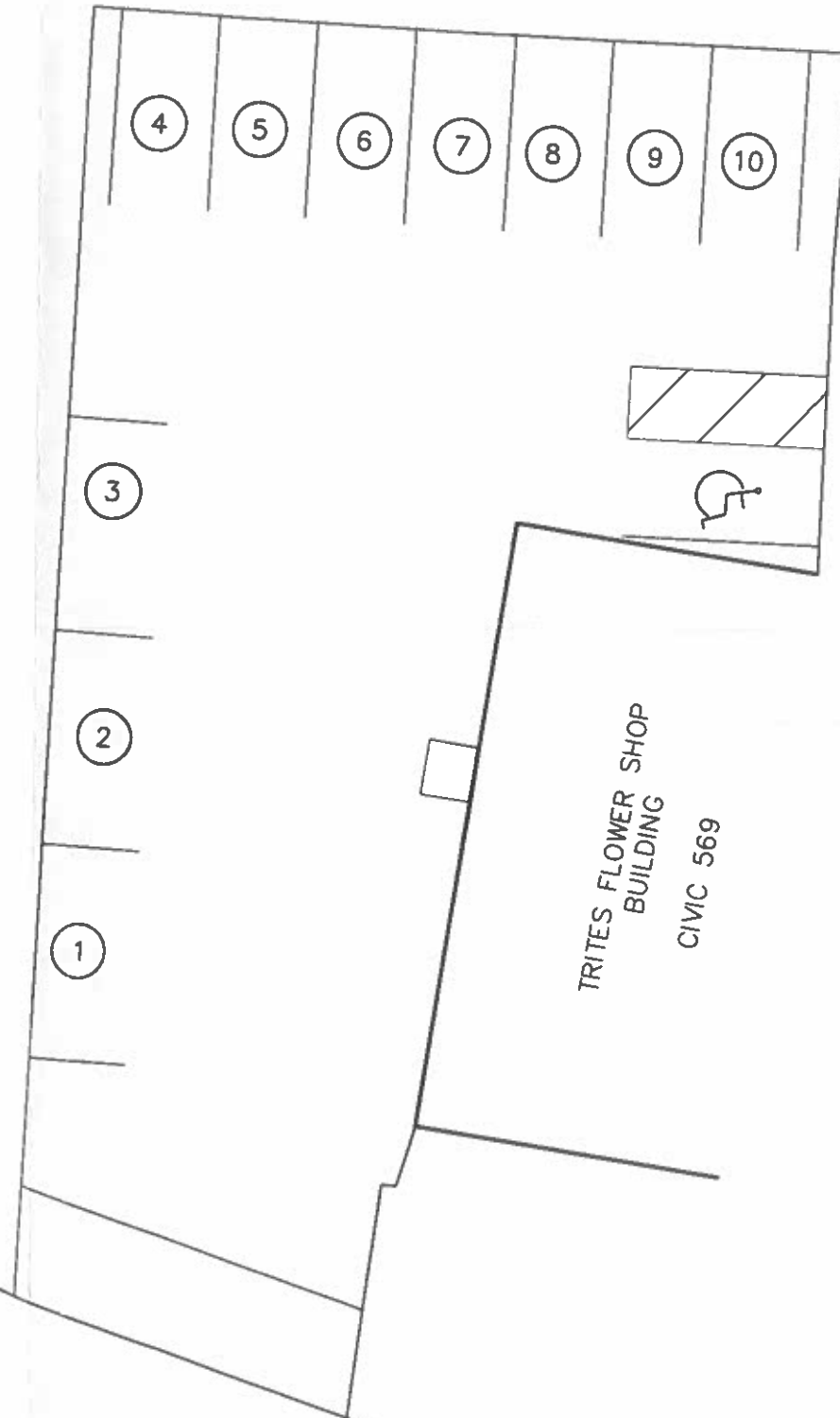

01438